

150035 – Arlington Heights Elementary School

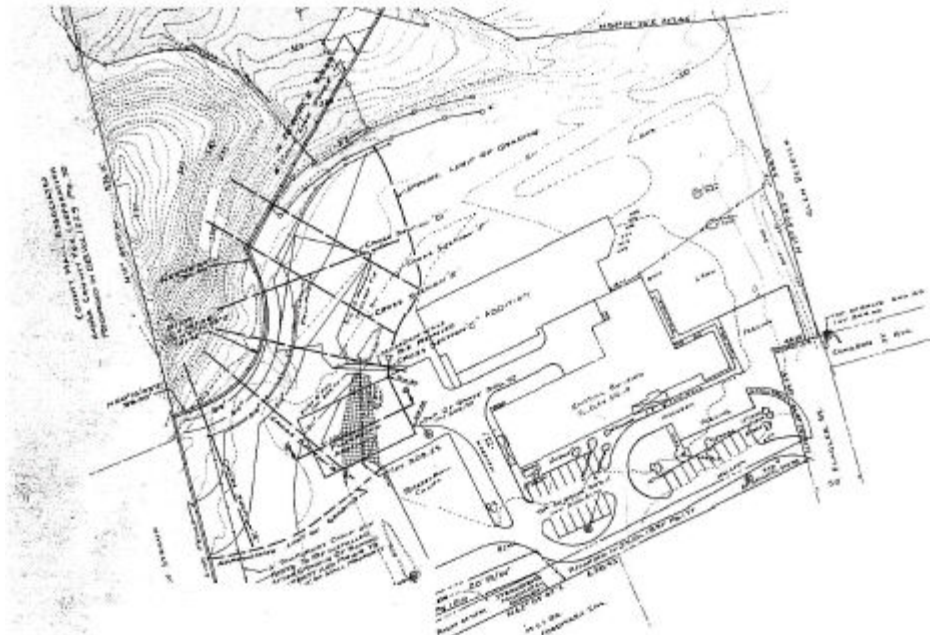

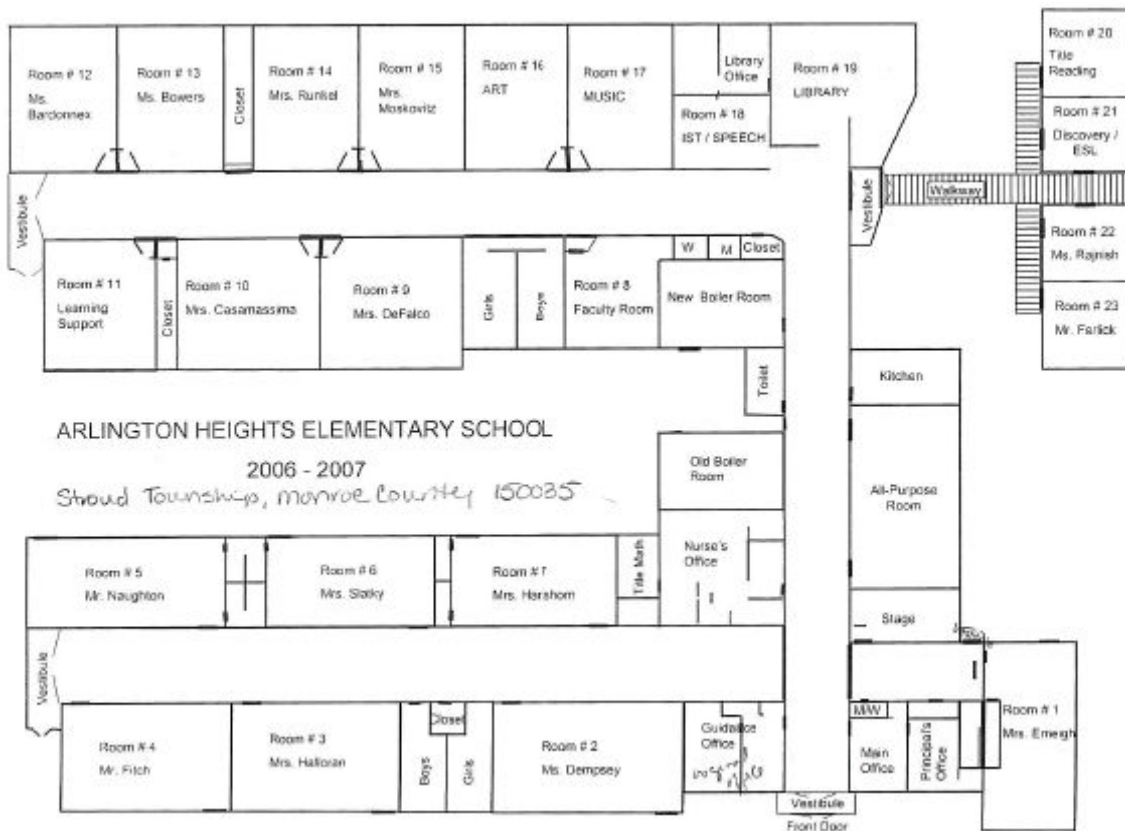

Site Plan for Arlington Heights Elementary School



Floor Plan for Arlington Heights Elementary School

150035; Arlington Heights Elementary School. This school is located at 1100 N. Ninth Street, Stroudsburg, Pennsylvania, in Stroud Township, Monroe County. It is part of the Stroudsburg Area School District. The 1957 school building is currently set back from the roadway, tucked behind a modern commercial building. An original circular driveway, parking area, flagpole, and landscaping are located in front of the school. A second circular driveway circles around the school for use during drop-off and pick-up time periods to separate bus and car traffic. A small visitor parking area is partially enclosed by chain-link fencing. A paved basketball court, a baseball field, and a shaved wood lot with modern playground equipment are located southwest of the school. Northwest of the school is an open field. The lot is surrounded by commercial properties and a thick treeline. Scattered trees and bushes are located around the school.

The 1957 core of the school building is essentially an L-plan structure. Interior hallways are flanked by classrooms, offices, and an all-purpose room. A 1989 addition added perpendicularly to one leg of the L transformed the building to a U-plan. The one-story 1957 concrete-block structure is clad in brick. The building sits on a concrete-block foundation. The materials covering the flat roof are unknown. The building has a brick interior chimney. The main entrance contains replacement metal-frame doors surrounded by fixed windows. The building is lit by replacement picture and awning windows. Some original window bays have been filled in with stuccoed panels. The 1989 addition was constructed with similar materials as the core; however, an added decorative detail of a tiled frieze embellishes the exterior walls. Two ca. 1998 modular classrooms are located northeast of the school, accessed via a covered boardwalk. These one-story flat-roof aluminum-sided frame structures house two to three classrooms each.

The hallways of the school feature vinyl floor tiles, painted concrete-block walls, acoustic ceiling tiles, fluorescent lights, water fountains with tiled backsplashes, and inset multi-pane doors. The all-purpose room features vinyl floor tiles, acoustic ceiling tiles, concrete-block walls, suspended basketball hoops, tables and chairs that fold out of the walls, and a stage inset into the southeast wall. A small kitchen serves as a serving area. Classrooms are carpeted. The bathrooms feature original tiles. The 1989 addition contains a new library (original wood library shelves were placed in classrooms), classrooms, and art and music rooms. During the construction project the original library was converted to a front office and principal's office. The original front office was converted to a guidance office.

Arlington Heights Elementary School was constructed in 1957 as one of two new elementary schools to accommodate students in the newly-consolidated Stroudsburg Area School system. Enrollment growth in the district necessitated the 1989 addition and the use of modular classrooms a decade later. The circular driveway around the school building was constructed ca. 1997 in response to a tragic accident.

(Debra Eppley, Principal, pers. com., November 30, 2006)

Historical information provided by Arlington Heights Elementary School.

United States Department of Agriculture

1959 Aerial Photograph AQW-3W-63. Created on May 6, 1959. On file at the Pennsylvania Geological Survey Library, Middletown,

Pennsylvania.

United States Geological Survey

1999 *Stroudsburg NW, PA Aerial Photograph*. USGS Reference Number 40075-H2-01-PHT. Created on April 24, 1999.

2001 *Stroudsburg, PA-NJ Quadrangle*. Topography compiled 1999. Planimetry derived from imagery taken 1999 and other sources. Survey control current as of 1955. Boundaries current as of 2001. Denver, CO.



Aerial View of Arlington Heights Elementary School

More Photos of Arlington Heights Elementary School

